

CONDENSED PROFILES

WHEELING & LAKE ERIE RAILROAD

WABASH PITTSBURGH TERMINAL RAILWAY

WEST SIDE BELT RAILROAD

Note - Elevations shown are
Top of Rail.

**CONDENSED
PROFILE.**

**Cleveland
Division**

W. & L. E. R. R.

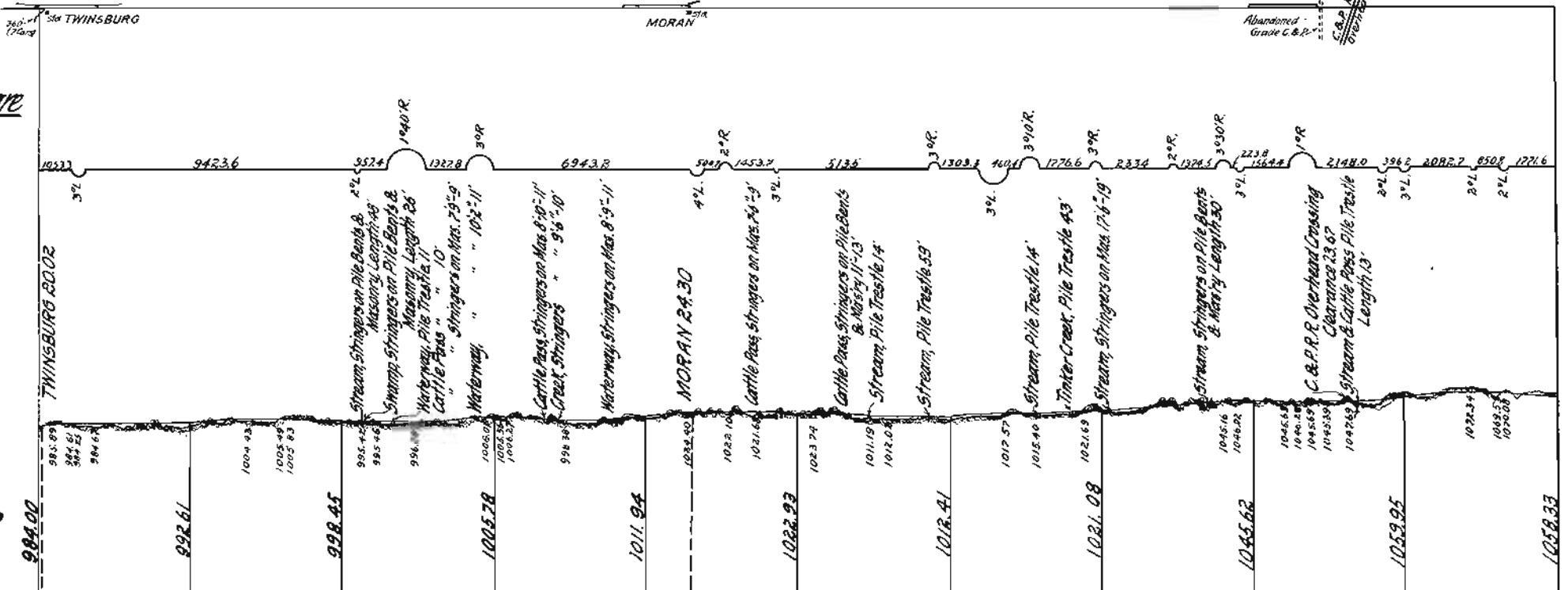

Datum Line, Elev. above Sea Level, 500'																							
Maximum Grade, Feet Per Mile		18.	21.	39.	22.	31.	39.	24.	39.	25.	33.	26.	23.	37.	20.	37.	29.	40.					
Distance from Ontario St. Depot Cleveland		0	21	60	82	113	152	176	215	244	277	303	327	364	384	421	450	490					
Curved Line Feet	From 0°00' to 2°00' Incl.			460.6		1548		906.3		4917		675.7		403.9		2080.9		2242		1258.3		480.0	
	" 2°00' " 4°00' "																		776.5		304.0		94.9
	" 4°00' " 6°00' "																						
	" 6°00' " 8°00' "																						
	" 8°00' " 10°00' "																						
	" 10°00' " 12°00' "																						
Total Curvature, Degrees				13°20'		53°41'		3°05'		3°05'		12°07'		63°26'		30°17'		25°05'		12°02'		14°56'	
" Ascents, North Feet				1.92		2.42		4.41		2.11		3.15		13.30		2.98		0.81		1.32		14.56	
" " South "				10.33		13.26		11.74		13.27		13.14		2.78		11.65		25.35		15.70		12.94	
Siding Feet				(618)		(2486)		(820)		(1268)		(338)		(268)		(337)		(526)		(237)		(337)	
Capacity Sidings, Cars				130.		550.		180.		600.		600.		600.		600.		600.		600.		600.	
Rail in Track		[Solid black bar]																					
Tie Placed Track		[Solid black bar]																					
Ballasted Track		[Solid black bar]																					
Fencing		[Solid black bar]																					
Date First Operated		[Solid black bar]																					

Sheet No. 8.

Note - Elevations shown are
Top of Rail.

CONDENSED PROFILE Cleveland Division W.&L.E.R.R.

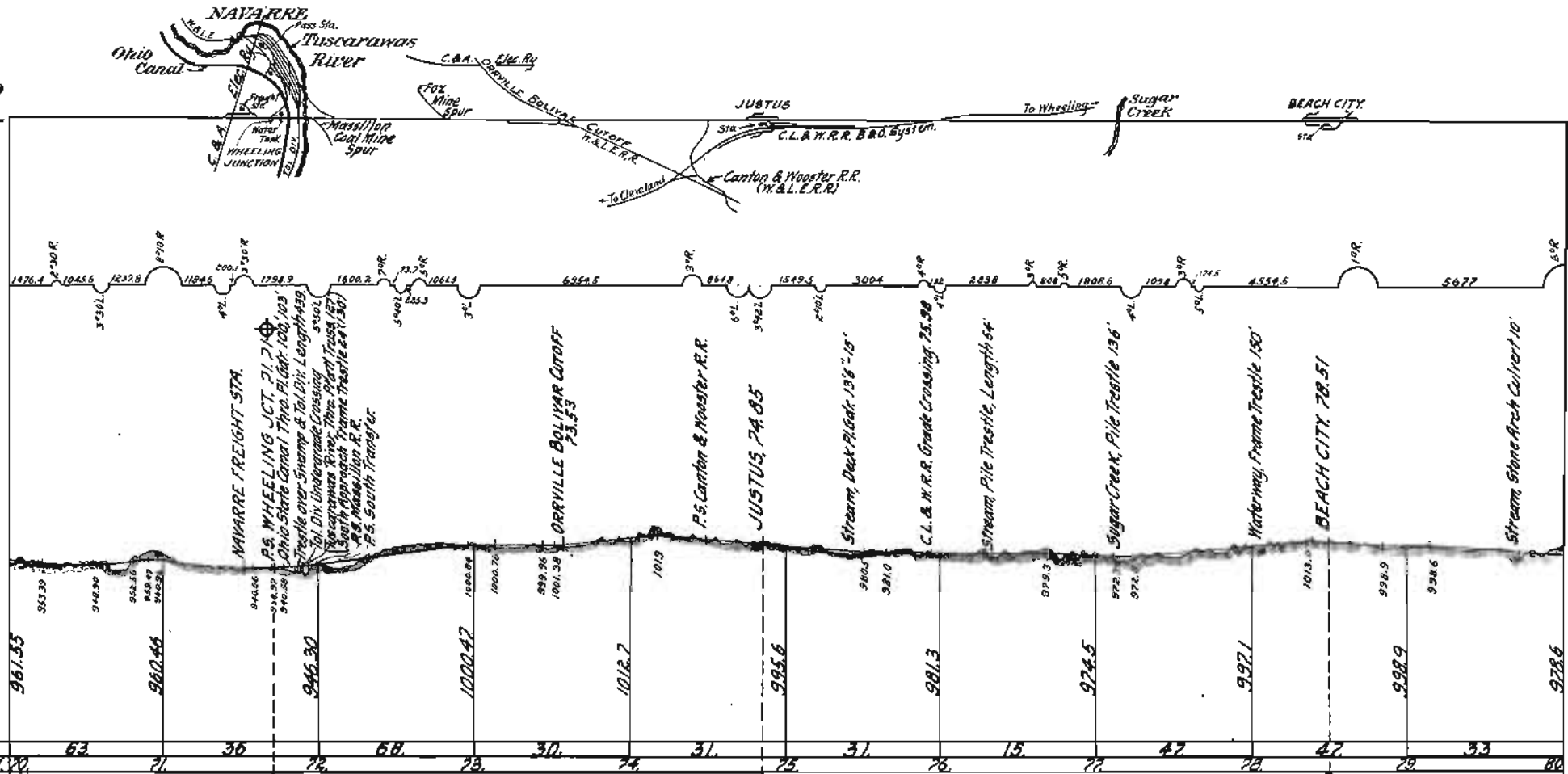

Datum Line Elev. above Sea Level 500'
Maximum Grade Feet Per Mile
Distance from Ontario St. Depot Cleveland, O.

	63	71	36	72	68	23	30	74	31	25	31	76	15	77	47	28	47	29	33	80
Curved Line	From 0+00' to 2+00' Inclu.																			
Feet	872.2	1165.8	604.8	924	1431.1	9927	376.3	1302	1284											
		373.7	1232.8	476.7	769.0															
	648.0	556.9																		
	79°45'	110°49'	119°19'	8°55'	93°07'	32°39'	26°01'	60°38'	12°50'	39°10'										
Ascents, North Feet	13.13	21.89	0.37	1.08	23.4	15.9	2.5	2.1	14.4	20.4										
Ascents, South Feet	12.06	7.73	34.54	13.31	6.3	1.6	0.7	24.7	16.5	0.1										
Sidings Feet	Freight Hae. (1082)(439) 226, 80.																			
Capacity Sidings Cars	Stk. Tracks (340)(1050) Transfer Tracks (1870) 60, 206, 206																			
Rail in Track																				
Tie Plated Track																				
Ballasted Track																				
Fencing																				
Date First Operated.																				

Sheet No. 2.

CONDENSED
PROFILE
Steubenville
Branch
W. & L. E. R. R.

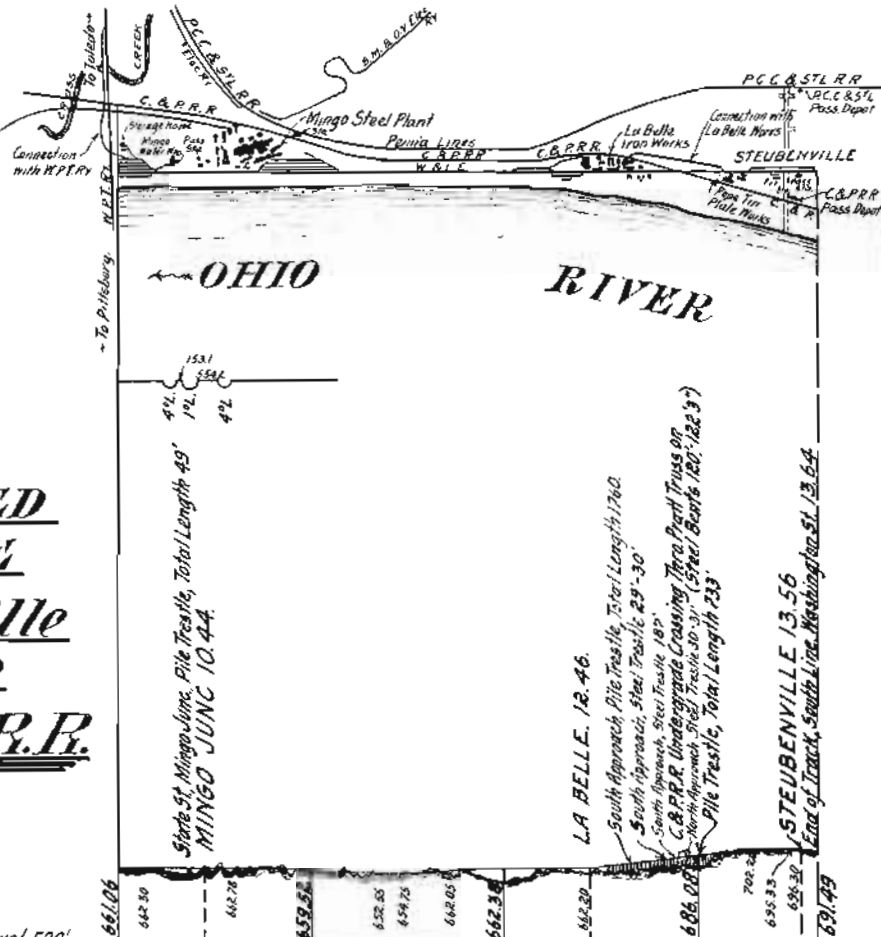

Datum Line, Elev. above Sea Level, 500'		65+00	66+50	68+00	69+49.30
Maximum Grade, Feet Per Mile		2.6	3.6	3.3	11.0
Distance from Connection with Main Line		10	11	12	13
Curved Line Feet	From 0+00 to 2+00 Incl.	356.6			
	" 2+01 " 4+00 "	714.4			
	" 4+01 " 6+00 "				
	" 6+01 " 8+00 "				
	" 8+01 " 10+00 "				
Total Curvature, Degrees		32.09'			
Total Ascents, North (Feet)		4.81	10.15	26.51	19.92
Total Ascents, South (Feet)		6.35	2.29	2.81	14.51
Sightings, Feet					
Capacity Sightings (Cars)		137C.	137C.	75C.	44C.
Rail in Track					
Tie Placed Track					
Ballasted Track					
Fencing					
Date First Operated					

**CONDENSED
PROFILE
W.&L.E.R.R.**

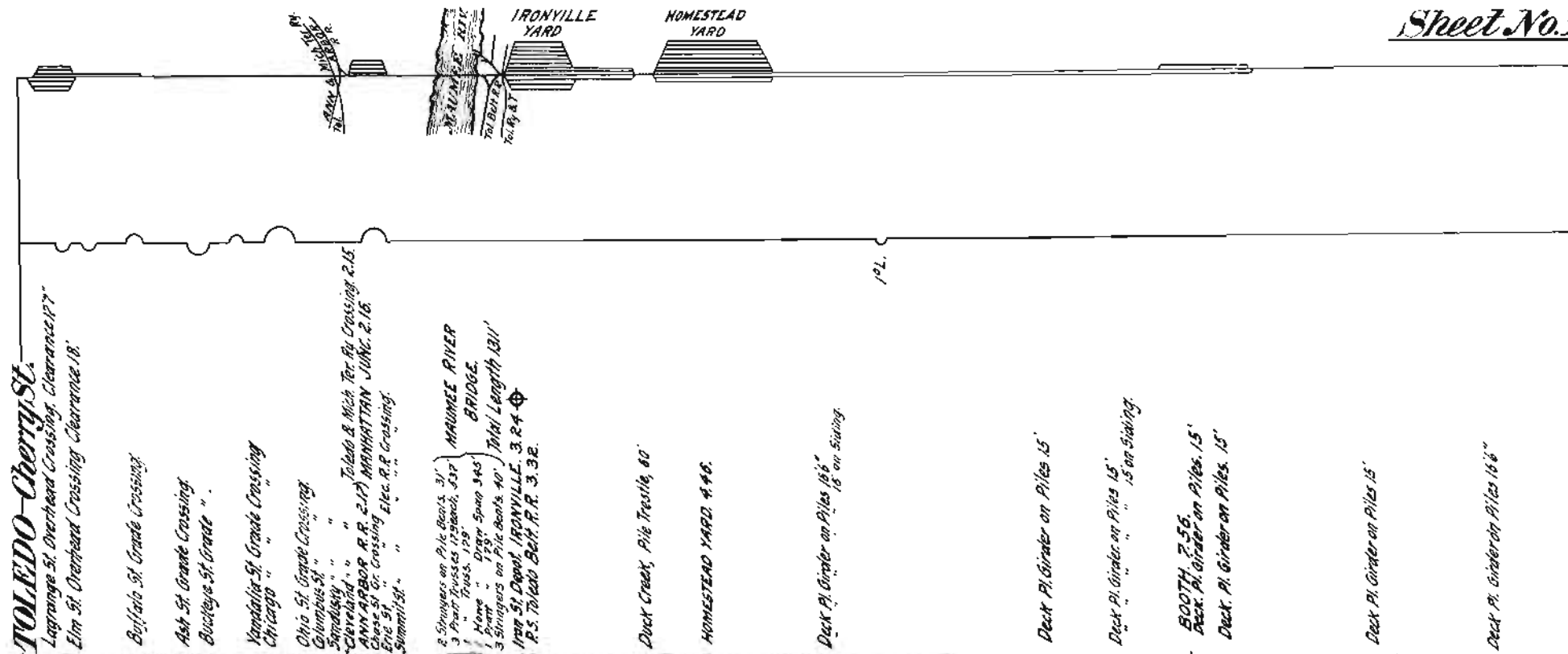

Datum Line Elev. above Sea Level, 500'
Maximum Grade, Feet Per Mile
Distance from Cherry St. Depot, Toledo.

	0	1	2	3	4	5	6	7	8	9	10
Curved Line, Feet.							397.0				
From 0°00' to 2°00' incl. "											
" 2°01' " 4°00' "											
" 4°01' " 6°00' "											
" 6°01' " 8°00' "											
" 8°01' " 10°00' "											
" 10°01' " 12°00' "											
Total Curvature, (Degrees)							3.58				
Ascents, East, (Feet)	6.84	11.43	6.31	3.12	9.71	2.89	1.86	3.28	2.94	2.16	
West, "	3.26	8.80	3.90	2.82	1.19	1.55	2.87	1.82	1.81	2.81	
Sidings, Feet.											
Capacity, Sidings, (Cars)	Cherry St. Yard 318C.		Manhattan Jct. 80C.	Ironville Yard 430C.	Homestead Yard 1091C.			Booth Siding 62C.			
Rail in Track											
Tie Plated Track											
Ballasted Track											
Fencing											
Date First Operated											

350' Water Tank
WILLISTON.

Turtle
Creek
-Six
TROWBRIDGE

Blair
Quarry
LIMESTONE.

CONDENSED
PROFILE.
W.&L.E.R.R.

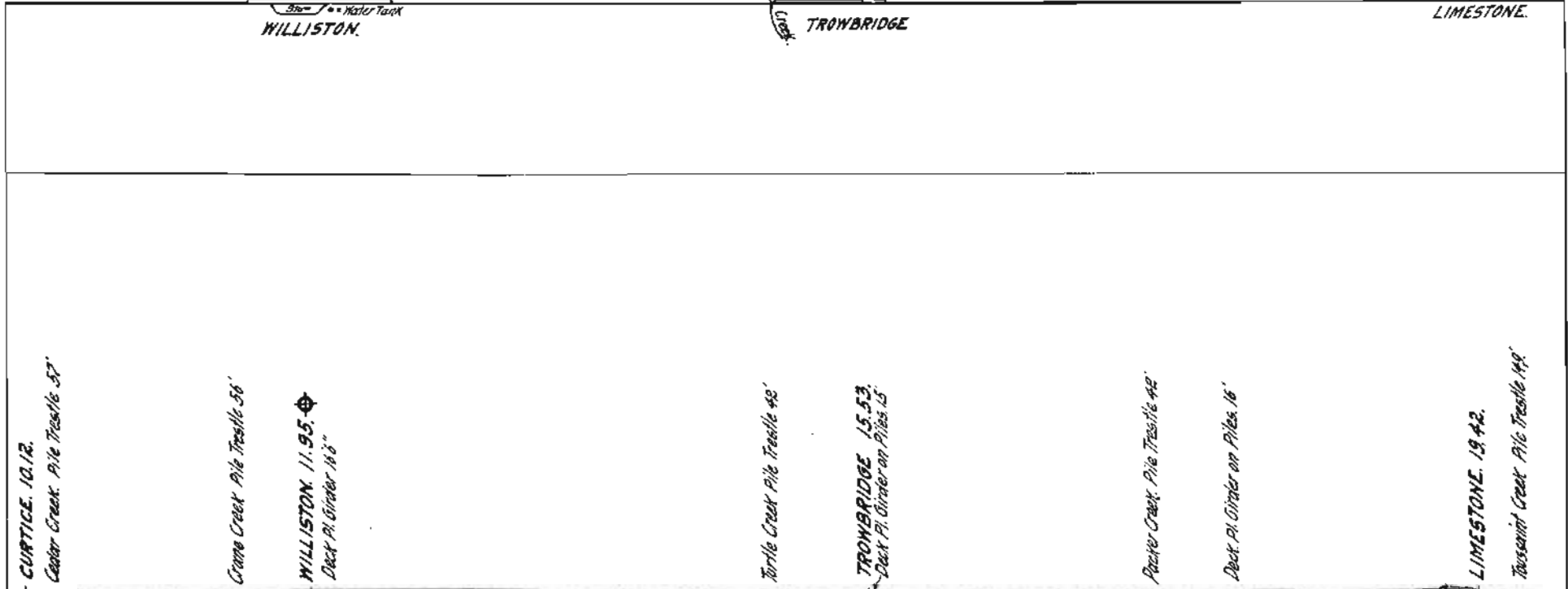

Datum Line Elev above Sea Level. 500'	599.2	598.8	598.4	598.0	597.6	597.2	596.8	596.4	596.0	595.6	595.2	594.8	594.4	594.0	593.6	593.2	592.8	592.4	592.0	
Maximum Grade, Feet Per Mile.	20.	11.	16.	16.	2.0	13.	4.0	14.	16.	15.	26.	16.	3.0	17.	5.0	18.	19.	19.	26.	20.
Distance from Cherry St. Toledo.	10.	11.	16.	16.	18.	22.	26.	30.	34.	38.	42.	46.	50.	54.	58.	62.	66.	70.	74.	78.
Curved Line Feet.																				
Total Curvature (Degrees)																				
Ascents, Feet		6.32	5.41	2.43	.61	1.72	3.80	3.78	4.72	2.98	6.95	2.63	2.12	2.98	1.99	13.03				
Descents, Feet		6.24	4.85	2.16	5.66	2.19	1.73	2.63	2.12											
Capacity Sidings Cars			Williston Sidings 242C					Trowbridge Sidings 226.					Limestone Sidings 163C.							
Rail in Track																				
Tie Plated Track																				
Ballasted "																				
Fencing																				
Date First Operated.																				

**CONDENSED
PROFILE.
W.&L.F.R.R.**

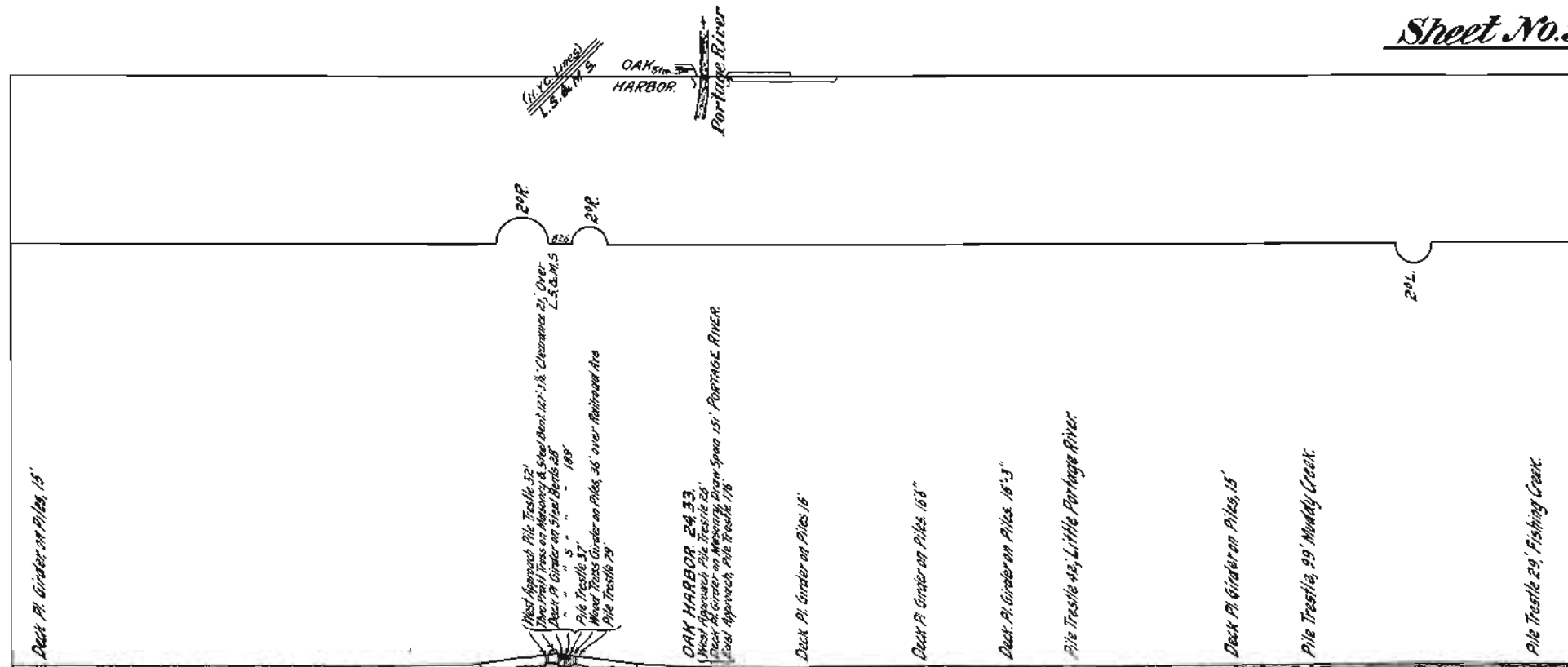

Datum Line, Elev above Sea Level, 500'		592.4	588.0	594.0	592.0	583.0	583.0	581.0	584.0	580.0	581.0	584.0	594.0
Maximum Grade, Feet Per Mile		10.	0.0	42.	42.	26.	21.	3.0	2.0	2.0	0.0		
Distances from Cherry St. Depot, Toledo.		20.	21.	22.	23.	24.	25.	26.	27.	28.	29.	30.	
Curved Line Feet.	From 0+00 to 2+00 Inclu					3007					658	549	
	" 2+01 " 4+00 "												
	" 4+01 " 6+00 "												
	" 6+01 " 8+00 "												
	" 8+01 " 10+00 "												
	" 10+01 " 12+00 "												
Total Curvatures (Degrees)						60°03'					130°09'	102°59'	
Ascends East, Feet		5.57	1.52	5.79	19.08	.86	5.39	2.73	2.45	3.47	2.23		
Descends West, Feet		.22	2.12	2.53	21.42	11.21	1.89	2.06	.56	2.35	1.77		
Sidings, Feet													
Capacity Sidings (Cars)													
Rail in Track		Oak Harbor Sidings 125c.											
Tie Plated Track													
Ballasted Track													
Fencing													
Date First Operated													



**CONDENSED
PROFILE
W. & L. E. R. R.**

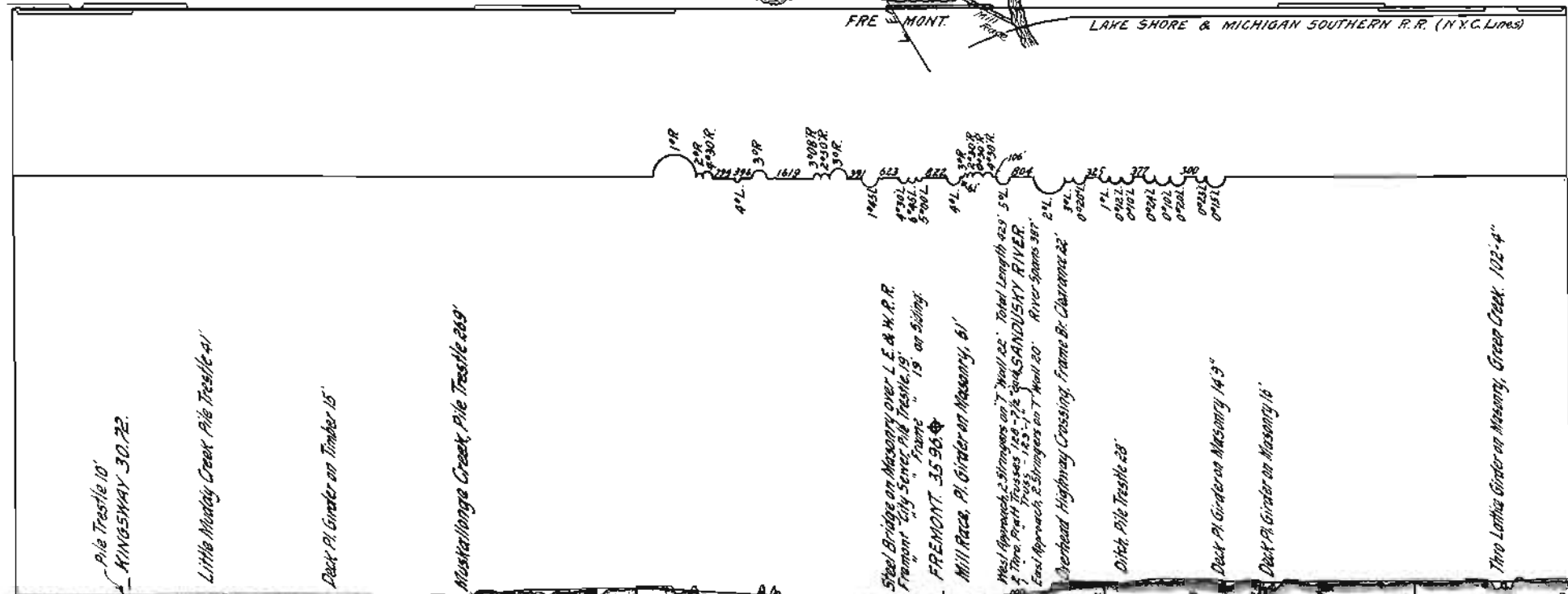

Datum Line, Elev above Sea Level, 500
 Maximum Grade, Feet Per Mile
 Distance from Cherry St. Depot, Toledo

	30	31	32	33	34	35	36	37	38	39	40
Curved Line											
Feet											
Total Curvature, (Degrees)											
Total Ascents, Feet											
" " Descent, "											
Stalings, (Feet)											
Capacity Stalings (Cars)											
Rail in Track											
Tie Planted Track											
Ballasted Track											
Fencing											
Date First Operated.											

Fremont 1866

1606

L.S. & M.S. R.R.

CLY. DE.

LAKE SHORE & MICHIGAN SOUTHERN R.R. (N.Y.C. LINES)

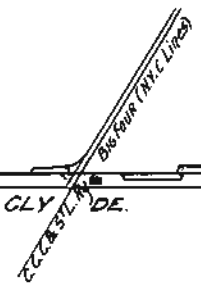

**CONDENSED
PROFILE
W.&L.E.R.R.**

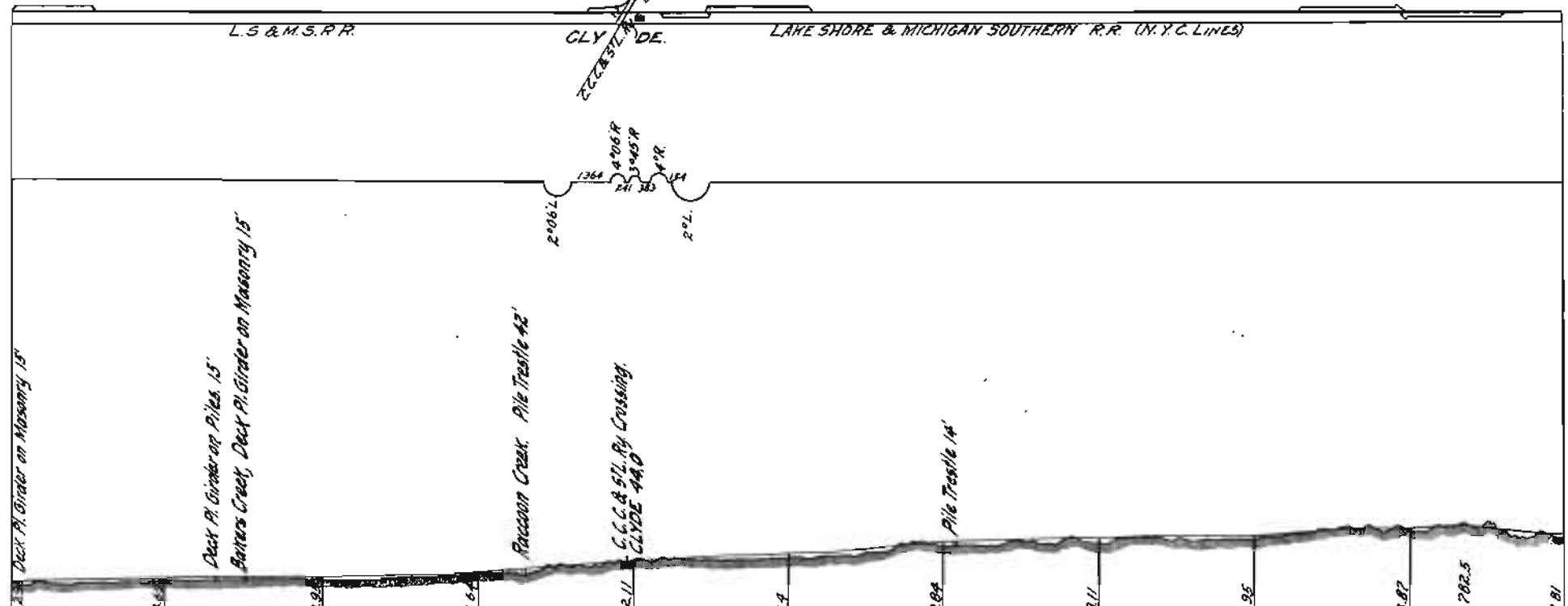

Datum Line Elev. above Sea Level 500'	616.1	614.4	612.9	611.6	610.1	608.1	606.1	604.4	602.9	601.4	600.1	598.6	597.1	595.6	594.1	592.6	591.1	589.6	588.1	586.6	585.1	583.6	582.1	580.6	579.1	
Maximum Grade, Feet Per Mile.		26.		5.		32.		32.		26.		42.		10.		18.		36.		26.						
Distance from Cherry St. Depot Toledo	40.		41.		42.		43.		44.		45.		46.		47.		48.		49.		50.					
Curved Line Feet.	From 0°00' to 2°00' incl.																									
	" 2°01' " 4°00' "							1017		1363																
	" 4°01' " 6°00' "							368		618																
	" 6°01' " 8°00' "																									
	" 8°01' " 10°00' "																									
" 10°01' " 12°00' "																										
Total Curvature.								39°28'		51°43'																
Ascants East (Feet)		10.33		5.31		11.85		31.76		18.75		29.44		9.24		9.99		18.54		8.63						
Descants West (")		1.93		.05		.16		.29		.46				.97		1.15		1.62		14.69						
Sidings (Feet)																										
Capacity Sidings (Cars)																										
Rail in Track.																										
Tie Plated Track.																										
Ballasted Track.																										
Fencing.																										
Date First Operated.																										

Clyde Sidings 119 C.

180 C.

CONDENSED
PROFILE
W.&L.E.R.R.

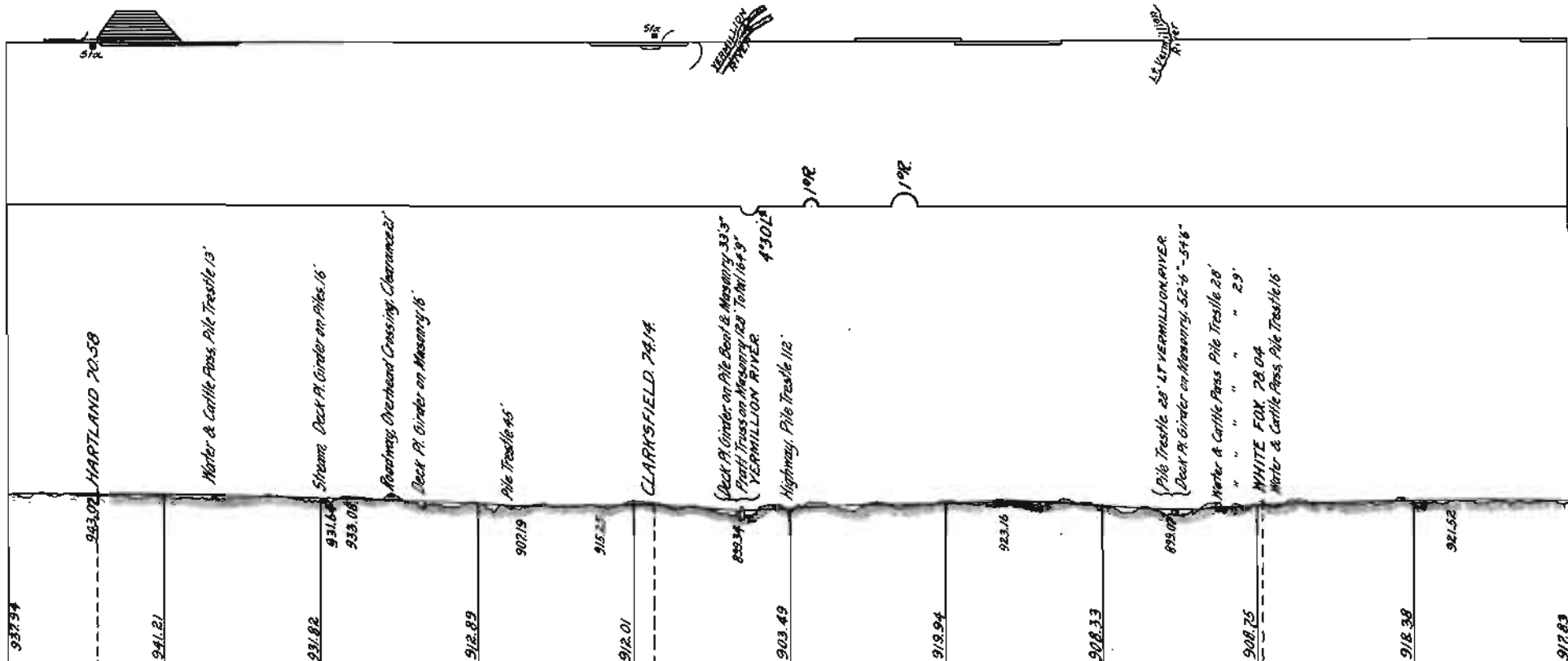

Datum Line, Elev above Sea Level, 500'
Maximum Grade, Feet Per Mile, 1.6
Distance from Cherry St. Depot, Toledo

	20	21	22	23	24	25	26	27	28	29	30
Curved Line Feet											
From 0°00' to 2°00' inclusive						1330					
" 2°01' " 4°00' "											
" 4°01' " 6°00' "						575					
" 6°01' " 8°00' "											
" 8°01' " 10°00' "											
" 10°01' " 12°00' "											
Total Curvature, Degrees											
" Ascant's, Equal, Feet	6.01	8.1	1.44	8.36	25.053	13.018'					
" " West "	2.74	9.60	20.37	9.84	4.56	16.99	3.28	10.10	10.32	5.13	
Sidings, Feet						.54	14.89	3.68	.69	3.70	
Capacity Sidings Cars	404 C. Hartland Yard.				Clarksville Sidings 25 C.		162 C.				
Rail in Track	[Solid black bar]										
Tie Plated Track	[Solid black bar]										
Ballasted Track	[Solid black bar]										
Fencing	[Solid black bar]										
Date First Operated	[Solid black bar]										

**CONDENSED
PROFILE
W. & L. E. R.R.**

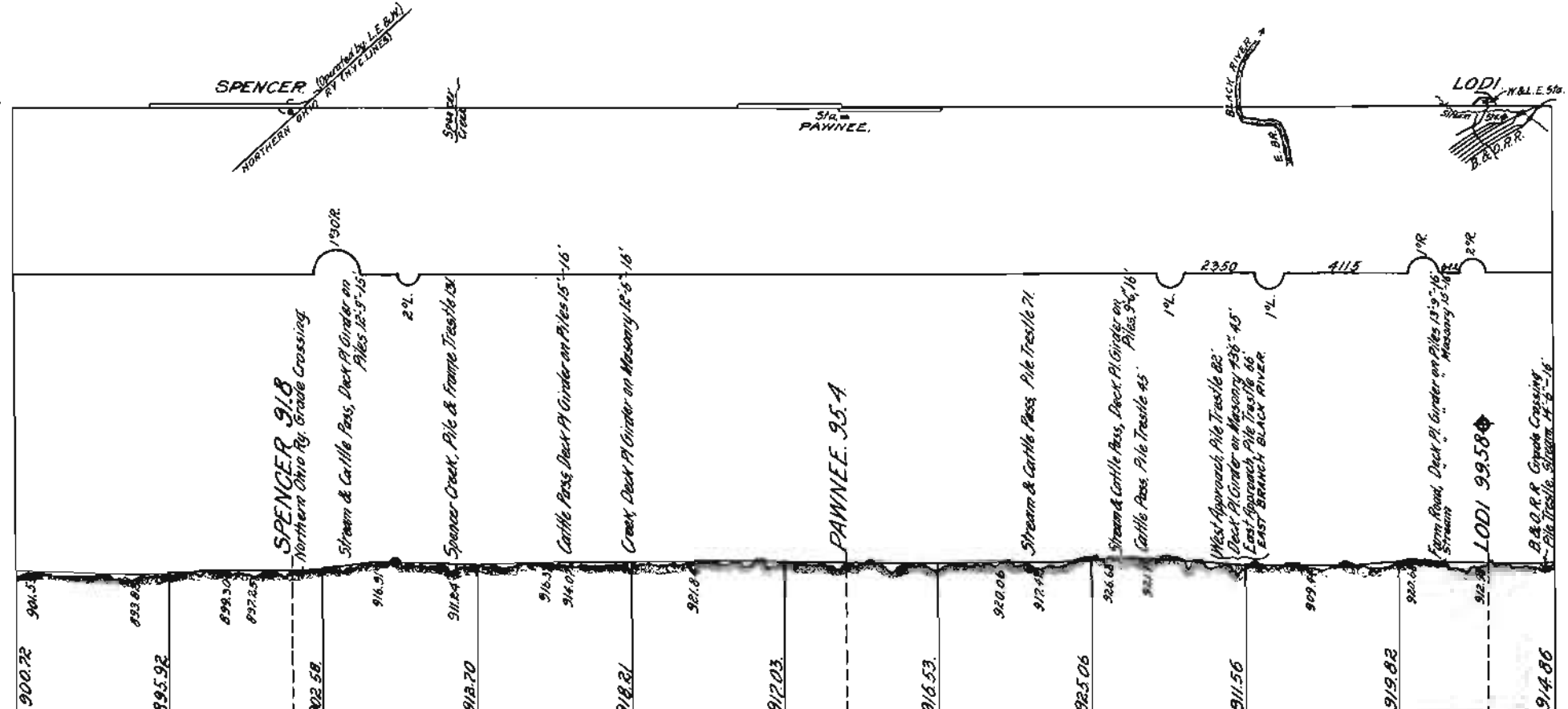

Datum Line, Elev. above Sea Level 500'		900.72	895.92	902.58	913.70	918.21	918.21	916.53	925.06	911.56	919.82	914.86
Maximum Grade, Feet Per Mile		10	20	31	10	13	10.0	26	33	12	26	
Distance from Cherry St. Depot, Toledo		90	91	92	93	94	95	96	97	98	99	100
Curved Line Feet	From 0°00' to 8°00' Incl.		336	2114					1035	1090	2163	
	" 2°01' " 4°00' "											
	" 4°01' " 6°00' "											
	" 6°01' " 8°00' "											
	" 8°01' " 10°00' "											
Total Curvature (Degrees)			5°08'	35°58'					10°21'	10°54'	32°46'	
" Ascents East (Feet)		3.14	9.02	15.78	7.91	4.05	2.82	11.40	2.51	11.08	4.66	
" " West (")		7.94	2.36	5.67	2.40	5.23	3.82	2.82	16.01	2.82	9.62	
Sidings, Feet			Spencer Siding 1000.				Pawnee Siding 1600.					
Capacity Sidings (Cars)												
Rail in Track		[Solid black bar]										
Tie Plated Track		[Solid black bar]										
Ballasted Track		[Solid black bar]										
Fencing		[Solid black bar]										
Date First Operated.												

**CONDENSED
PROFILE
W.&L.E.R.R.**

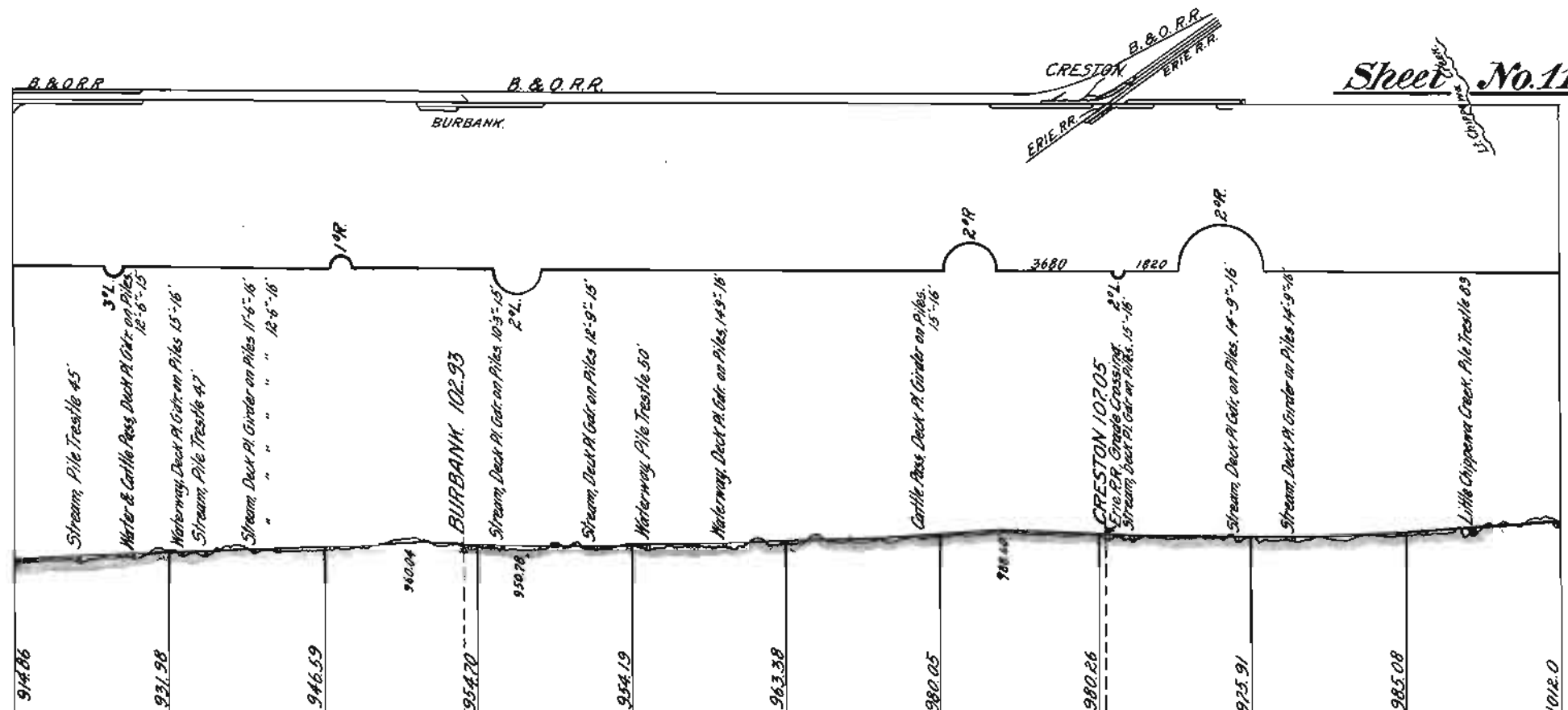

Datum Line, Elev. above Sea Level 500'											
Maximum Grade, Feet Per Mile	19	19	30	12	13	34	34	13	10	31	
Distance, From Cherry St. Depot, Toledo	100	101	102	103	104	105	106	107	108	109	110
Curved Line Feet	From 0°00' to 2°00' incl.		700	1662			1870	3070	294		
	" 2°01' " 4°00' "	633									
	" 4°01' " 6°00' "										
	" 6°01' " 8°00' "										
	" 8°01' " 10°00' "										
Total Curvature, (Degrees)	18°59'		7°00'	33°14'			37°24'	61°24'	5°53'		
" Ascents, East (Feet)	12.85	14.78	13.55	3.87	10.49	16.75	8.55	3.66	10.31	26.96	
" " West (Feet)	.75	1.77	5.44	4.38	1.30	.08	6.34	8.01	1.34	.04	
Sidings (Feet)											
Capacity Sidings (Cars)	Lodi Siding 100 C.						Creston Sidings 180 C.				
Rail in Track	[Blank]										
Tie Plated Track	[Blank]										
Ballasted Track	[Blank]										
Fencing	[Blank]										
Date First Operated	[Blank]										

**CONDENSED
PROFILE
W. & L. E. R. R.**

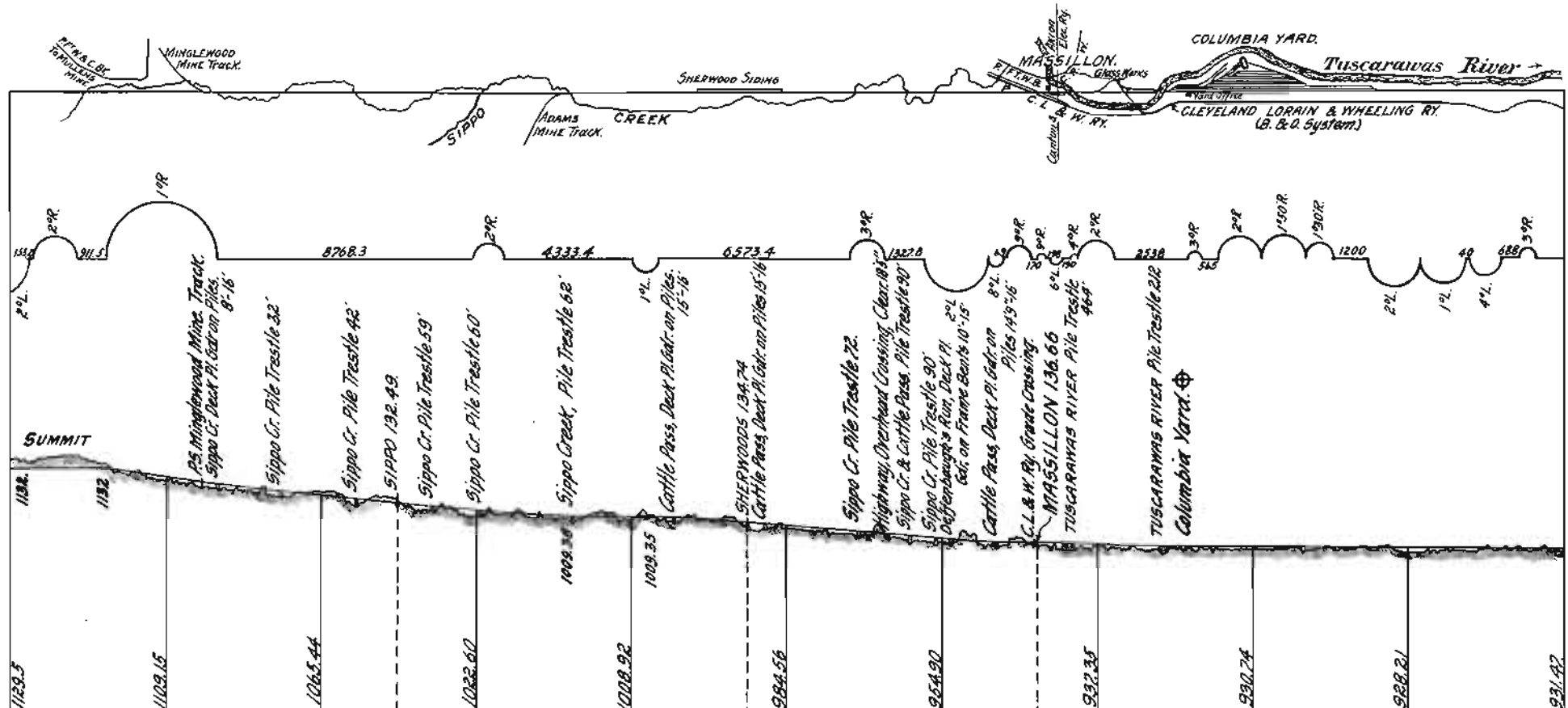

Datum Line, Elev. above Sea Level 500		130	131	132	133	134	135	136	137	138	139	140
Maximum Grade, Feet Per Mile		53	33	46	28	32	32	27	27	138	0.0	8
Distance from Cherry St. Depot Toledo		130	131	132	133	134	135	136	137	138	139	140
Curved Line Feet	From 0+00 to 2+00'	4213.3	16827	104	9826	826.6	509	2415	1682	4080	1991	
	" 2+01' " 4+00'						1282.2	200	495		1672	
	" 4+01' " 6+00'							507				
	" 6+01' " 8+00'							500				
	" 8+01' " 10+00'							1091				
Total Curvature (Degrees)		64°34'	16°53'	2°05'	19°45'	8°16'	48°39'	219°30'	48°29'	74°41'	83°48'	
" Ascents East, Feet		2.50			1.05	69		3.79	2.40	1.86	6.81	
" " West "		22.85	43.71	42.84	14.73	25.05	20.66	21.34	9.01	4.39	3.55	
Siding's Feet												
Capacity Sidings (Cars)						52 Cars					Columbia Yard 8840	
Rail in Track												
Tie Placed Track												
Ballasted Track												
Fencing												
Date First Operated												

**CONDENSED
PROFILE
W. & L. E. R. R.**

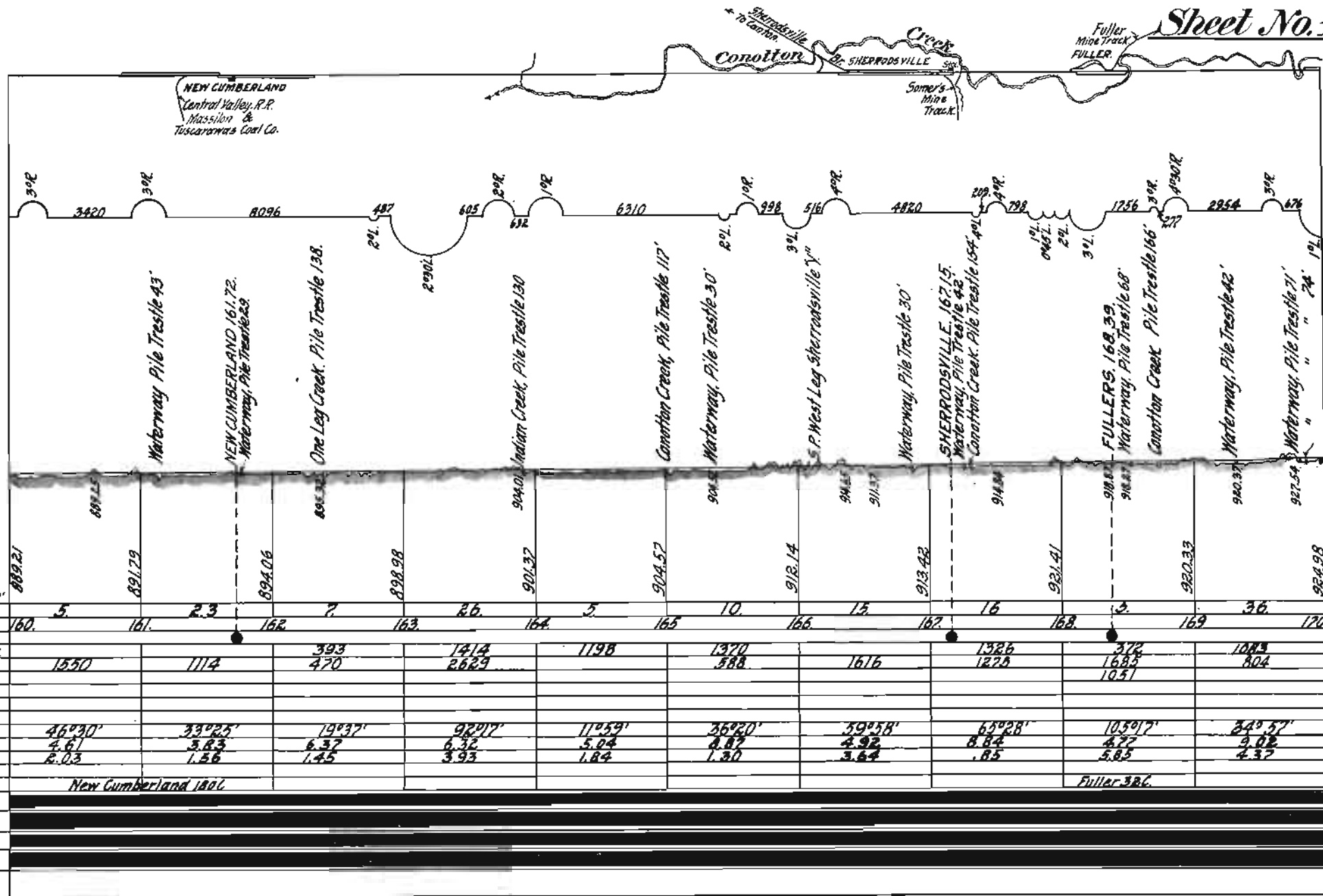

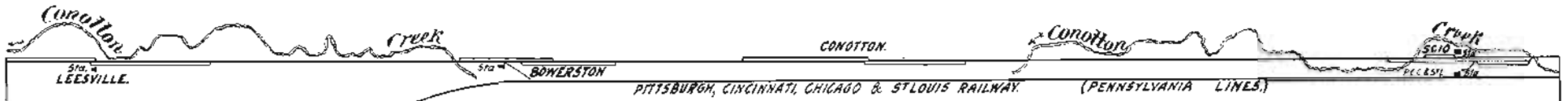

**CONDENSED
PROFILE
W. & L. N. R. P.**

Datum Line, Elev. above Sea Level 500'
Maximum Grade, Feet Per Mile
Distance from Cherry St. Depot Toledo

	170	171	172	173	174	175	176	177	178	179	180	
Curved Line Feet	22.53	109.2	257.8	200	3288.1	943.3	1668.3	1752.2	1325	572.5		
From 0°00' to 2°00' incl.												
" 2°01' to 4°00' "												
" 4°01' to 6°00' "												
" 6°01' to 8°00' "												
" 8°01' to 10°00' "												
" 10°01' to 12°00' "												
Total Curvature, Degrees	22°38'	32°46'	51°34'	47°48'	98°38'	18°52'	55°45'	26°17'	13°15'	12°20'		
" Ascends East, Feet	4.80	23.77	5.01	11.90	7.08	3.18	19.31	3.05	4.88	14.31		
" West, "	1.98	6.83	3.29	.50	4.07	3.74	4.36	5.77	0.66	0.11		
Sidings, Feet	Leesville Sidings 1746.			Conotton Sidings 1800.						5010 1150.		
Capacity Sidings Cars												
Rail in Track												
Tie Plated Track												
Ballasted Track												
Fencing												
Date First Operated												

